

R05

R07

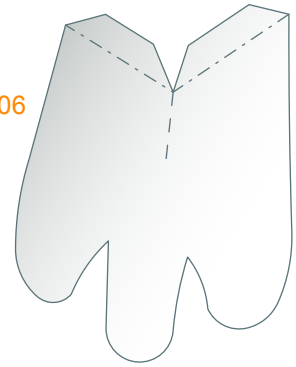

R06



R08

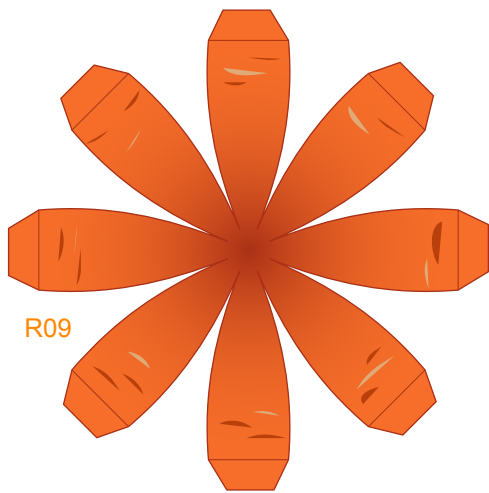

R09

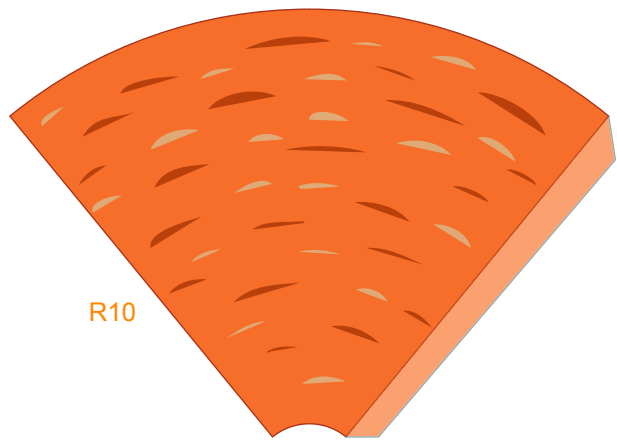

R10

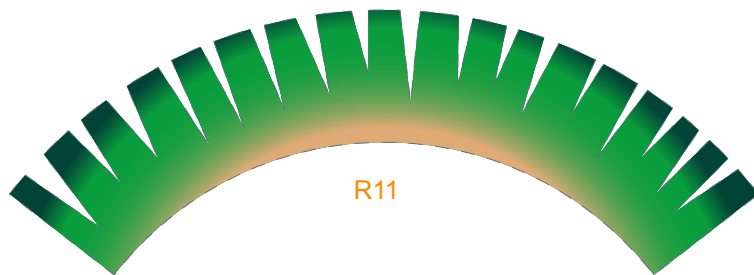

R11

Assembly Instructions

--- Outward fold

--- Inward fold

✗ Cut away parts

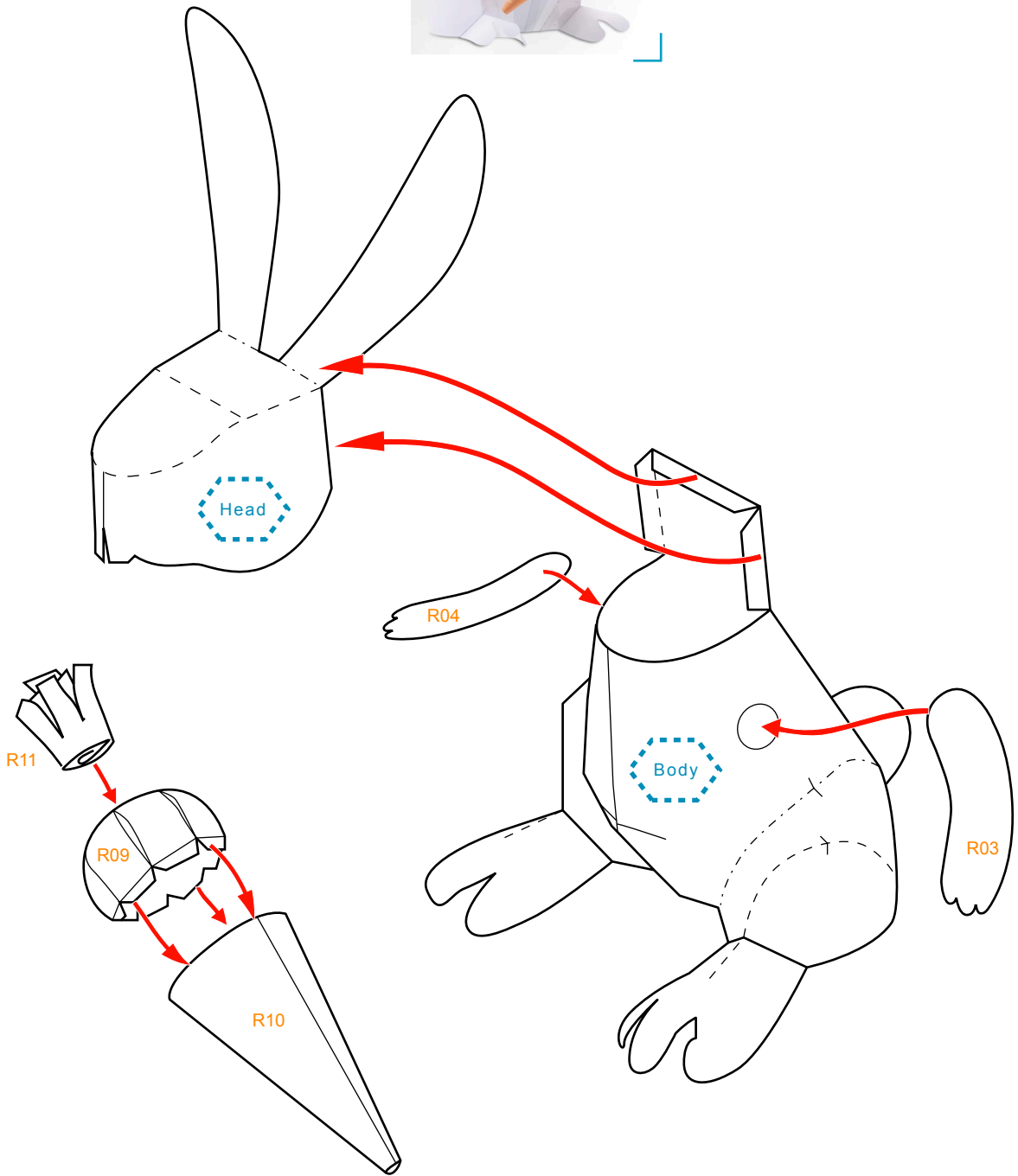

Basic steps

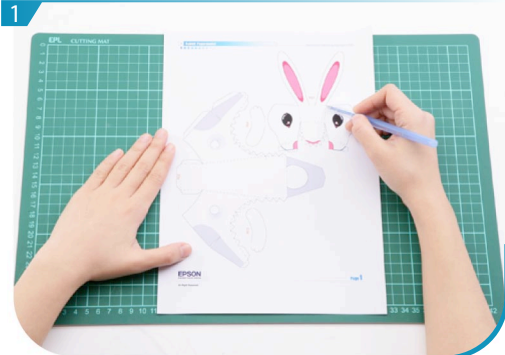

Use a pen whose ink has dried out, or a tracer, to trace lines first.

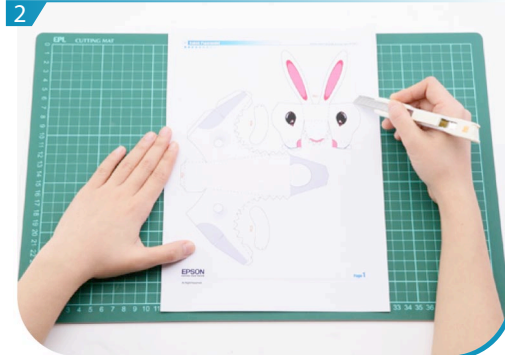

Separate all parts along the lines. Mark their identity on the back to avoid confusion.

Carrots

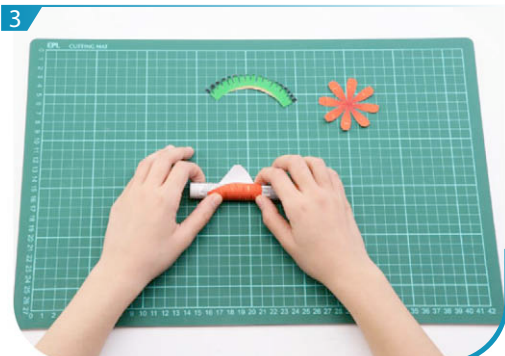

First use a cylindrical pen to roll R10 and R11.

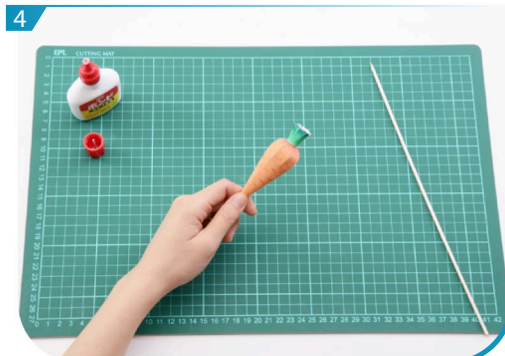

Fold and glue R09, R10 and R11 together according to the assembly instruction to form carrot.

Head

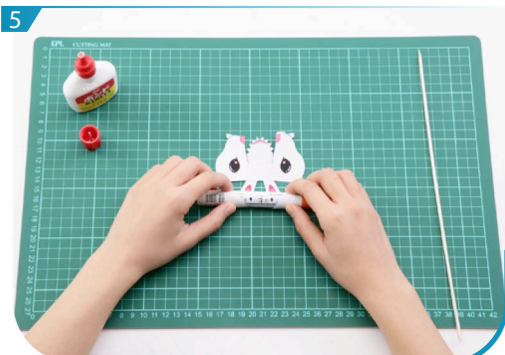

Use a cylindrical pen to roll R01 the ears of rabbit.

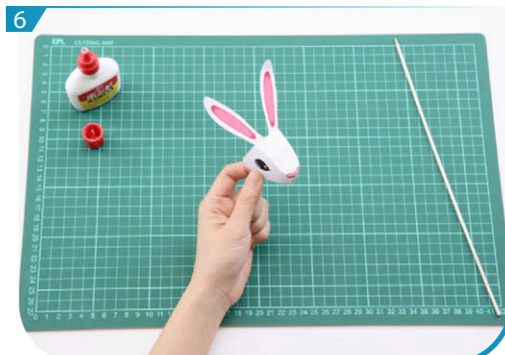

Fold and glue R01.

Body



Fold and glue R02, R05 and R07 respectively.

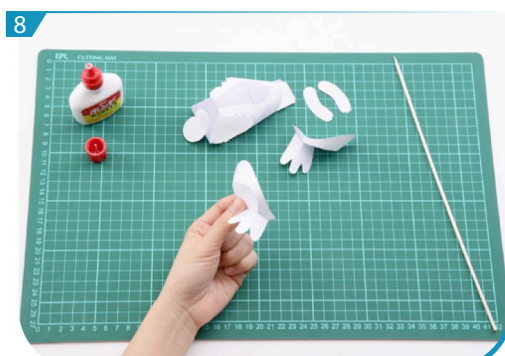

Fold and glue R05 with R06, R07 with R08 to form legs.

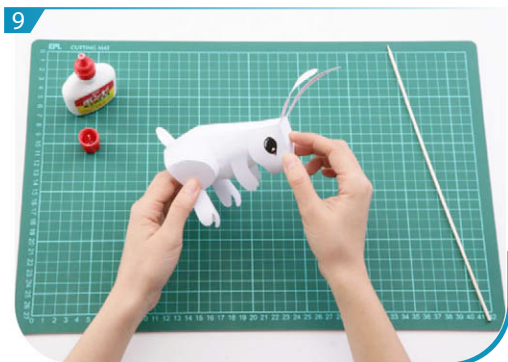

Fold and glue R01, R02, R03, R04, R05 and R07 according to the assembly instruction. Lovely Easter Rabbit is now done.